

THIS IS ISSUED IN STRICT CONFIDENCE THAT IT IS NOT USED AS A BASIS FOR MANUFACTURE OR SALE AND THAT IT IS NOT COPIED, REPRINTED OR DISCLOSED TO A THIRD PARTY EITHER WHOLLY OR IN PART WITHOUT THE PRIOR WRITTEN CONSENT OF CAL TEST ELECTRONICS, INC.

REVISIONS			
REV.	DESCRIPTION	DATE	APPROVED
A	INITIAL RELEASE	1/4/2022	B. HANSEN

NOTES:

- MATERIAL:
INSULATOR: PA 66 (NYLON)
JACK: BRASS, Ni PLATED
ROUND PANEL NUT: BRASS, Ni PLATING.
- RATING:
VOLTAGE: 600V CAT II (IEC 61010)
CURRENT: 10 A MAX
RESISTANCE: <5 mΩ
TEMPERATURE: -20°C TO 80°C.
- INSULATOR THREAD: M8 x 0.75.
-  MAXIMUM PANEL THICKNESS: 8.5mm (.33).
- RECOMMENDED ASSEMBLY TOOL: CT3076.
- ROUND PANEL NUT REPLACEMENT: CT3081.
- RoHS 2 COMPLIANT.

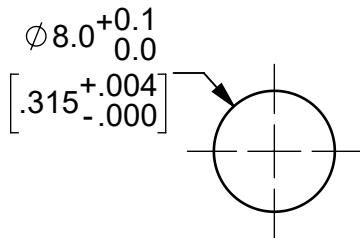
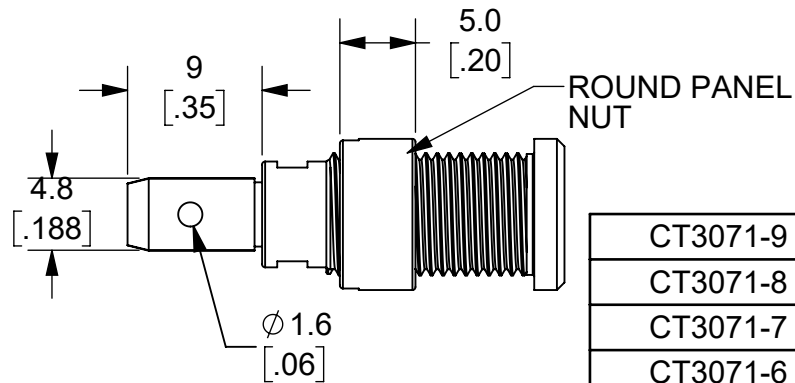
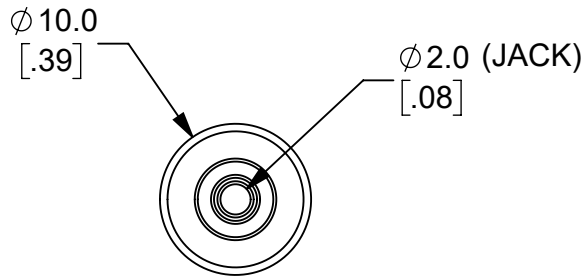
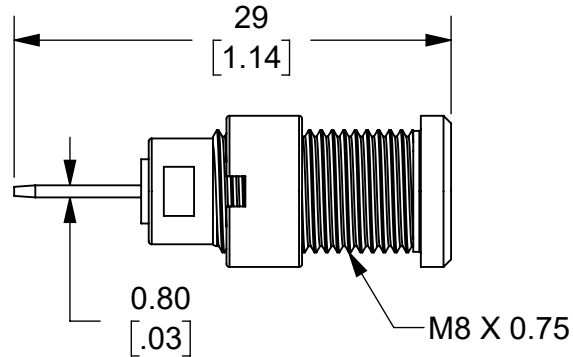
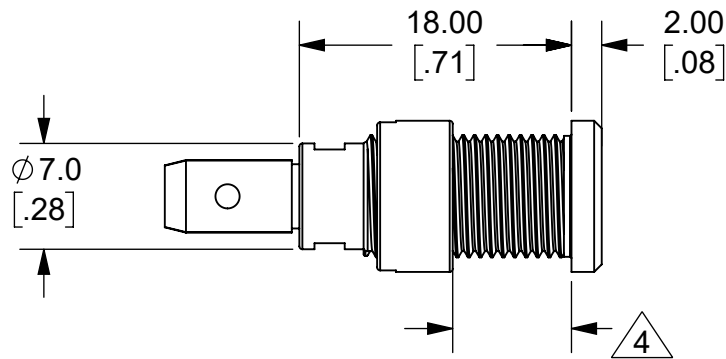

PANEL MOUNT HOLE

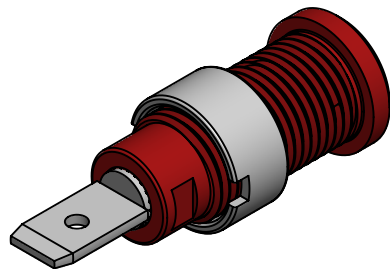

ISOMETRIC VIEW

CT3071-9	WHITE	SPECIAL ORDER
CT3071-8	GREY	SPECIAL ORDER
CT3071-7	PURPLE	SPECIAL ORDER
CT3071-6	BLUE	SPECIAL ORDER
CT3071-5	GREEN	SPECIAL ORDER
CT3071-4	YELLOW	SPECIAL ORDER
CT3071-3	ORANGE	SPECIAL ORDER
CT3071-2	RED	STANDARD
CT3071-0	BLACK	STANDARD
PART NUMBER	INSULATOR COLOR	NOTES / REFERENCE

PART NUMBER TABLE

THIRD ANGLE PROJECTION

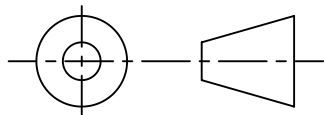

REFERENCE

UNLESS OTHERWISE SPECIFIED DIMENSIONS ARE IN MILLIMETERS
TOLERANCES ARE:
X.X = ±0.5 X.X* = ±0.5*
X.XX = ±0.25
X.XXX = ±0.125
DO NOT SCALE DRAWING

MATERIAL
SEE NOTES

TREATMENT
N/A

FINISH
SEE NOTES

PROJECT NO.

APPROVALS

DRAWN G. GORGONIO

CHECKER W.D.H.

ENGR. B. HANSEN

DESIGN ACTIVITY

DATE

1/4/2022

1/4/2022

1/4/2022

METRIC



22820 Savi Ranch Prky.
Yorba Linda, CA 92887
USA

TITLE

2mm SHEATHED JACK, PANEL MOUNT
w/4.8mm QUICK CONNECT

SIZE

B

CAGE CODE

43F45

DWG. NO.

CT3071

REV.

A

SCALE 2:1

SHEET 1 OF 1