

THIS IS ISSUED IN STRICT CONFIDENCE THAT IT IS NOT USED AS A BASIS FOR MANUFACTURE OR SALE AND THAT IT IS NOT COPIED, REPRINTED OR DISCLOSED TO A THIRD PARTY EITHER WHOLLY OR IN PART WITHOUT THE PRIOR WRITTEN CONSENT OF CAL TEST ELECTRONICS, INC.

REVISIONS			
REV.	DESCRIPTION	DATE	APPROVED
A	INITIAL RELEASE	11/15/2023	B. Hansen

- NOTES:**
- ALL SPECIFICATIONS SUBJECT TO CHANGE WITHOUT NOTICE.
 - ADAPTER TO MEET OR EXCEED ALL SPECIFICATIONS PER MIL-PRF-39012.
 - MATING DIMENSIONS IN ACCORDANCE WITH MIL-STD-348.
 - FREQUENCY RANGE SPECIFICATIONS ARE FOR REFERENCE AND ARE DEPENDENT ON CABLE TYPE AND OTHER APPLICATION SPECIFIC CONDITIONS.
 - MATERIAL:
 - BODY: BRASS, NICKEL PLATED
 - CENTER CONTACT: BRASS, GOLD PLATED
 - SLEEVE: BRASS, NICKEL PLATED
 - DIELECTRIC: DELRIN
 - ELECTRICAL:
 - IMPEDANCE: 50Ω
 - FREQUENCY: DC - 2 GHz
 - WORKING VOLTAGE: 500 Vrms
 - CABLE TYPE:
 - THE CT4507 IS INTENDED TO BE USED WITH THE FOLLOWING TYPES OF CABLE:
 - RG-142
 - ASSEMBLY INSTRUCTIONS ON SHEET 2 OF 2.
 - MECHANICAL:
 - TEMPERATURE RANGE: -20°C TO +80°C
 - RoHS AND REACH COMPLIANT

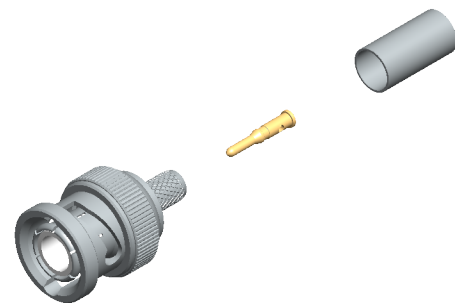
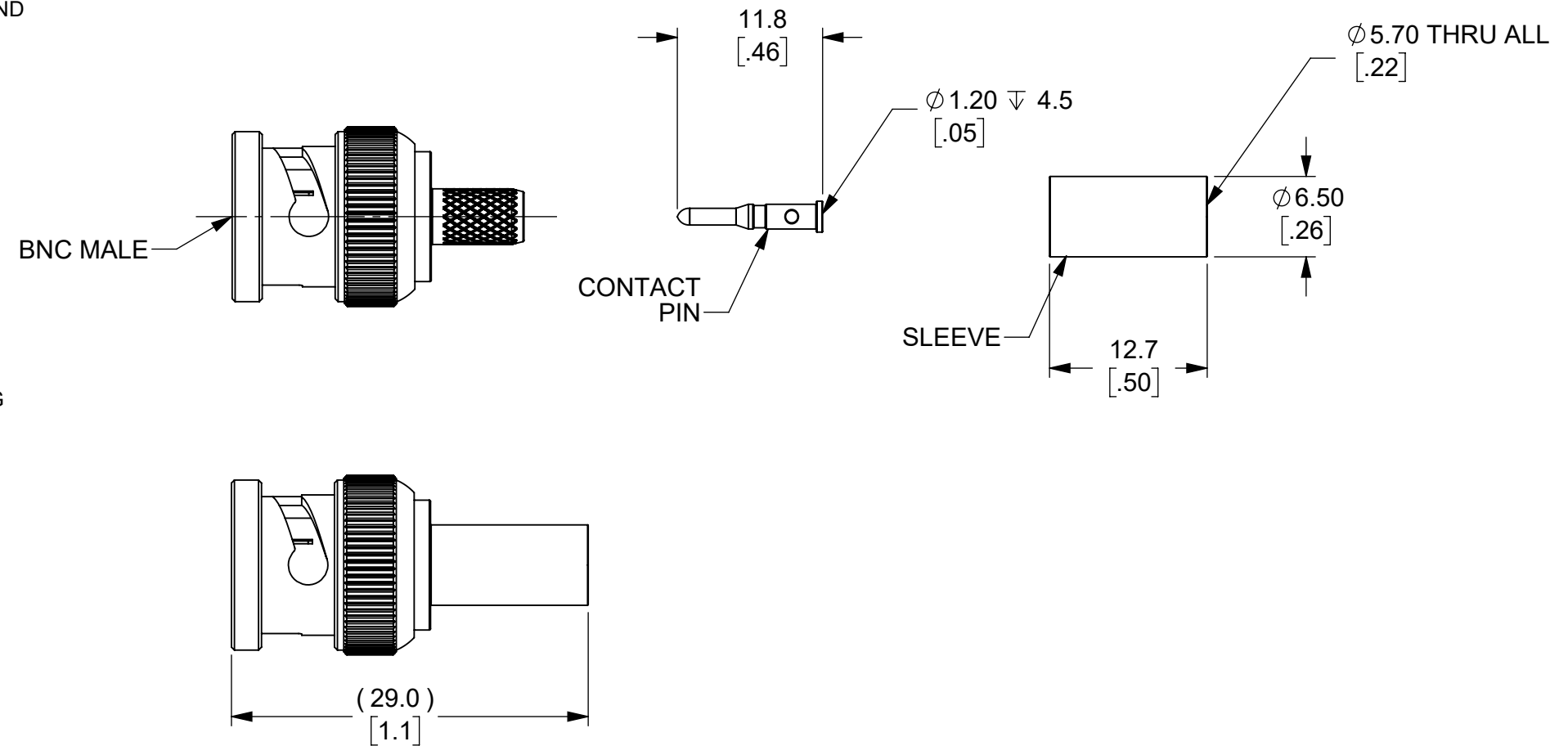

ISOMETRIC VIEW
FULL SCALE

CT4507	CONNECTOR, CRIMP	IN-SERIES CONNECTOR
MODEL NUMBER	CONFIGURATION	NOTES / REFERENCE
MODEL NUMBER TABLE		
THIRD ANGLE PROJECTION 	PROJECT NO.	METRIC 22820 Savi Ranch Prky. Yorba Linda, CA 92887 USA
	UNLESS OTHERWISE SPECIFIED DIMENSIONS ARE IN MILLIMETERS TOLERANCES ARE: X.X = ±0.5 X.X* = ±0.5* X.XX = ±0.25 X.XXX = ±0.125 DO NOT SCALE DRAWING	
MATERIAL SEE NOTES	DATE	TITLE
TREATMENT NONE	DRAWN GSG 10/26/2023	CONNECTOR, BNC MALE DIY CRIMP
FINISH SEE NOTES	CHECKER B. HANSEN 10/26/2023	
REFERENCE	ENGR. B. HANSEN 10/26/2023	SIZE B
	DESIGN ACTIVITY	CAGE CODE 43F45
		DWG. NO. CT4507
		SCALE 2:1
		REV. A
		SHEET 1 OF 2

4

3

2

1

THIS IS ISSUED IN STRICT CONFIDENCE THAT IT IS NOT USED AS A BASIS FOR MANUFACTURE OR SALE AND THAT IT IS NOT COPIED, REPRINTED OR DISCLOSED TO A THIRD PARTY EITHER WHOLLY OR IN PART WITHOUT THE PRIOR WRITTEN CONSENT OF CAL TEST ELECTRONICS, INC.

ASSEMBLY INSTRUCTIONS:

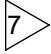
1. SLIDE CRIMP SLEEVE ONTO CABLE JACKET
2. STRIP COAXIAL CABLE END 
3. INSERT CENTER CONDUCTOR INTO PIN HOLE DIAMETER
4. CRIMP OR SOLDER PIN TO CENTER CONDUCTOR
5. FLARE THE OUTER CONDUCTOR BRAID
6. INSERT CONTACT PIN FIRMLY INTO POSITION IN THE BNC CONNECTOR
7. ENSURE THE OUTER CONDUCTOR BRAID SEATS PROPERLY AND UNIFORMLY AROUND THE OUTER SURFACE OF THE BNC CRIMP POST
8. SLIDE SLEEVE OVER BRAID AND POST
9. CRIMP SLEEVE TO THE BNC CRIMP POST USING THE APPROPRIATE CRIMPING TOOL

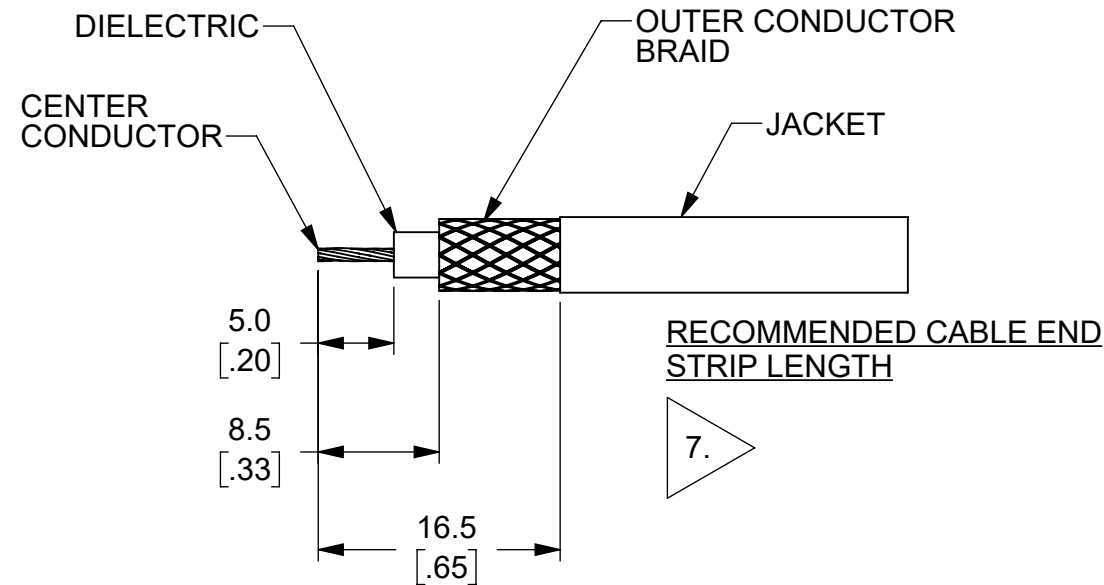
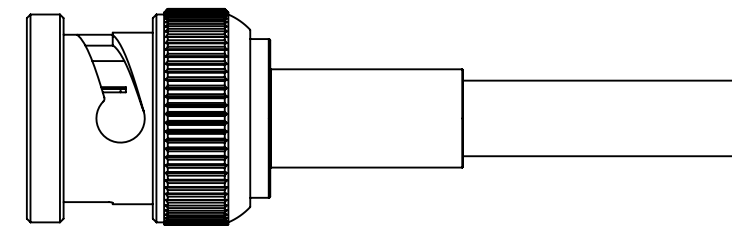
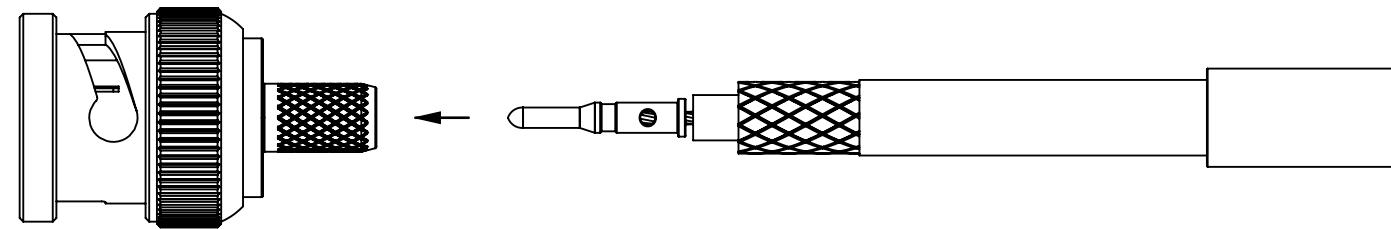
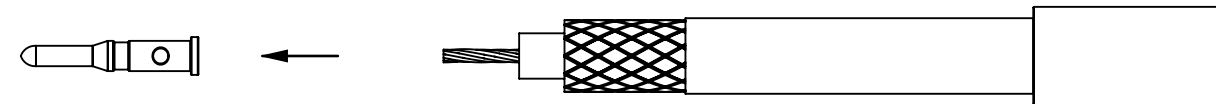
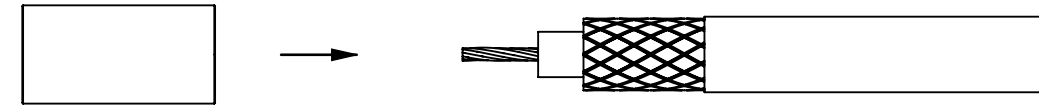

D

D

C

C

B

B

A

A

METRIC	APPROVALS	DATE	SIZE	CAGE CODE	DWG. NO.	REV.
	DRAWN GSG	10/26/2023	B	43F45	CT4507	A
	CHECKER B. HANSEN	10/26/2023	SCALE 2:1	SHEET 2 OF 2		

4

3

2

1